

Important: Read all instructions prior to installation.

LED High Bay Light



Safety and Notes

- Product should be installed and serviced by a certified electrician in accordance with applicable national, state, and local building and electrical codes.
- To reduce the risk of electric shock, ensure that the main power source and circuit breakers are switched off before performing any installation or wiring procedures.
- Avoid looking directly into lamp when illuminated.
- Ensure all mounts are securely attached and will support the weight of the fixture. Failure to properly support fixture may result in damage or injury, for which the manufacturer does not assume responsibility.

Specifications

Environmental Specifications	
Operating Temperature	-40–45 °C (-40–113 °F)
IP Rating	IP65

Wiring Diagram

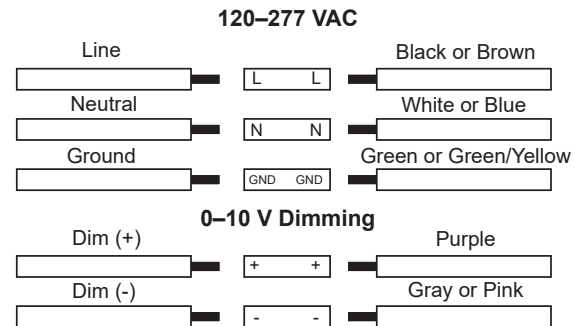

Installation Instructions

1. Remove plug and make CCT and wattage selections.
2. Remove plug and install motion sensor (optional).
3. If uninstalled, thread mounting hook into hole on top of fixture.
4. Tighten mounting hook and tighten set screw to secure.
5. Mount fixture and tighten safety screw to secure fixture.
6. With the supply power off, make all wiring connections.
7. Apply supply power.

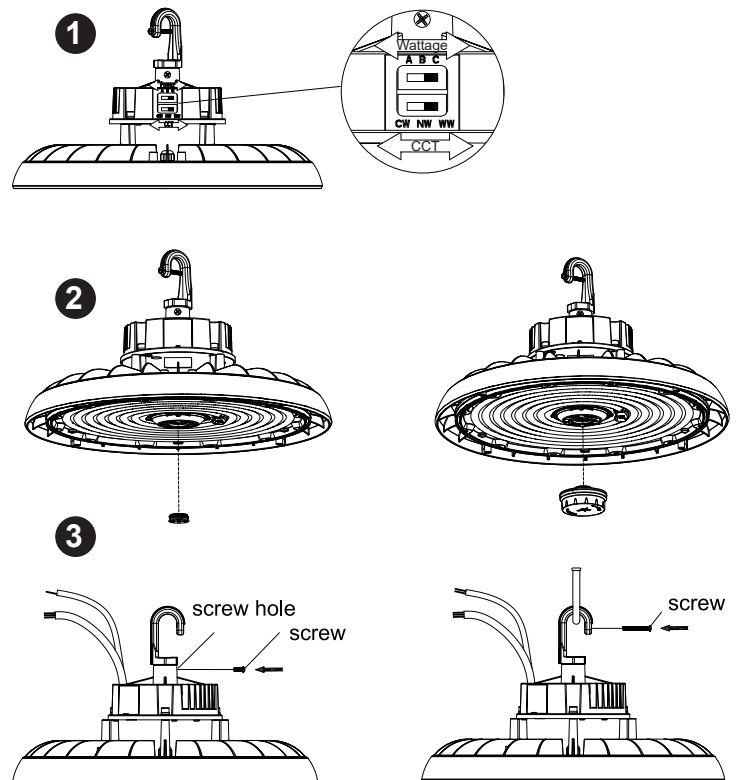

Polycarbonate Reflector Installation Instructions

